

Waveguide Isolator, 89-97GHz (split band) WR10 Flange, 0.5 Watts

WR10 coverage is 75-110GHz

The dimensions are the same on the A, B surfaces.

Units: mm.

Tolerance: ± 0.2 unless otherwise stated.

Material: Silver plated brass.

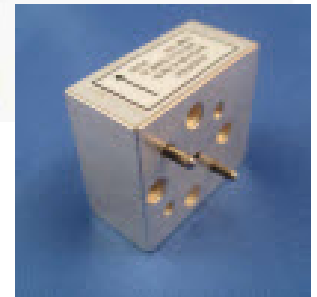
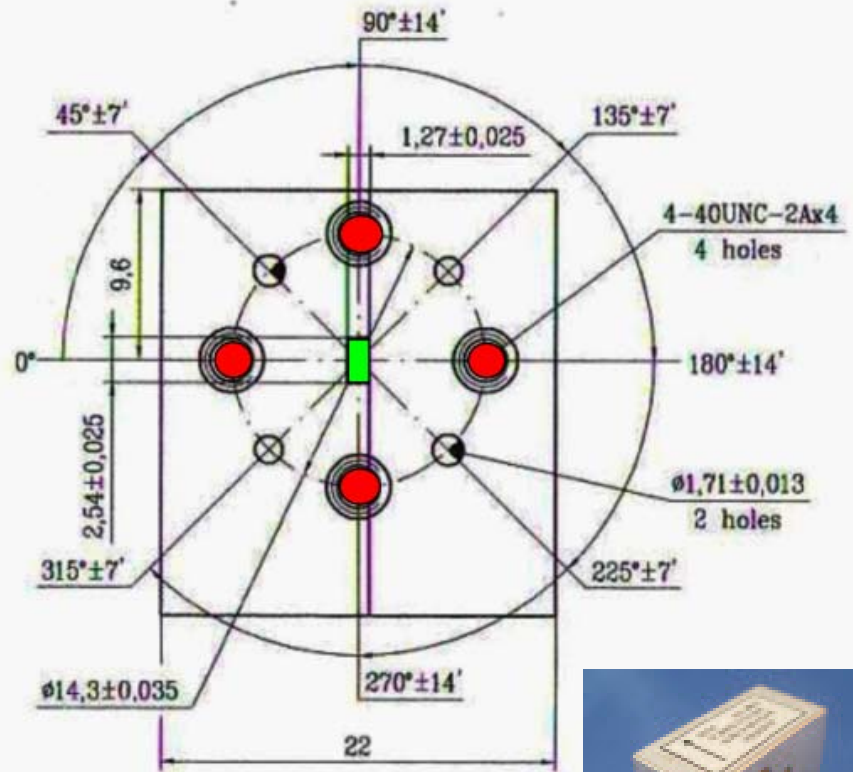
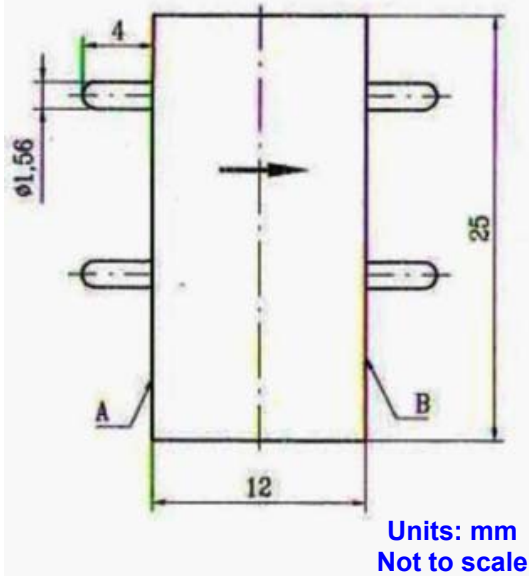

Direction of RF:	
R	Default ▶
L	◀

Order Examples: **RADI-F89.5-94.5-WR10-0.5WR**
I=ISOLATOR

Specifications				Units
Frequency	89.5-94.5	89-97	93.5-94.5	GHz
Band Width	5.0	10	1	GHz
Insertion loss	0.5	1.5	0.4	dB (maximum)
Isolation	18	12	20	dB (minimum)
VSWR	1.7	1.7	1.25	
Interface	WR-10, UG387/U	WR-10, UG387/U	WR-10, UG387/U	
Rated power	10W peak, 0.5W avg.	10W peak, 0.5W avg.	10W peak, 0.5W avg.	Forward and reverse
Vibration	3G @ +50 °C	3G @ +50 °C	3G @ +50 °C	5 to 500 Hz sinewave
Shock (6 ms)	6G op., 15G non op.	6G op., 15G non op.	6G op., 15G non op.	5 to 500 Hz sinewave
Humidity	95% op, 60% non op.	95% op, 60% non op.	95% op, 60% non op.	at 50 °C
Op. Temp.	0 to 50	0 to 50	-30 to +70	°C
Non Op. Temp.	-55 to 80	-55 to 80	-55 to 80	°C