

RADI-8.2-12.4G-WR90-1WR Isolator 8.2-12.4GHz

WR90 coverage is 8.2-12.4GHz

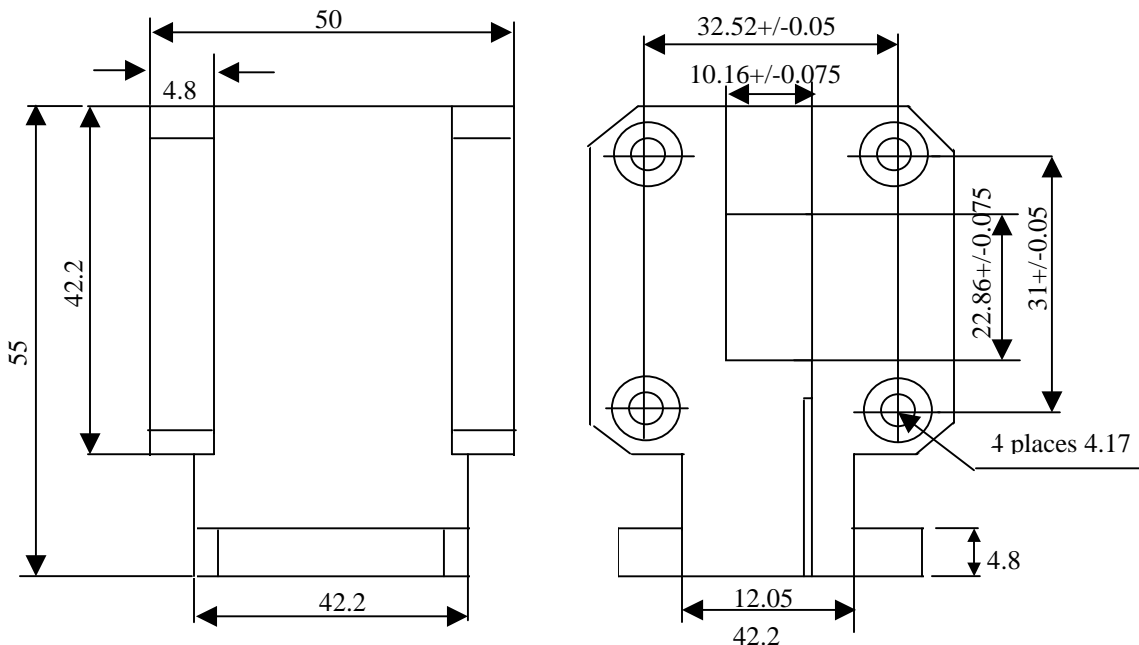

WG Flange Interface

Hole Options-X (per flange)

- 1 **4** off 4-40 UNC 2B
0.17”(4.32) deep
- 2 **4** Thru holes
0.116/.110 dia +/-0.01;
- 3 **4** off M3 x 5-6H
(5 pitch,6H thread class)
x 0.280”(7.1) deep
- 4 **4** off 6-32 UNC Thru

Units: mm.

Tolerance: ± 0.2 unless otherwise stated.

RADI-8.2-12.4-WR90-1WR

Specifications:

Frequency	8.2-12.4	9.36-9.84	GHz
Insertion loss	0.2	0.2	dB
Isolation	24	24	dB
VSWR	1.15	1.15	:1 max
Power Forward	1Watts	1Watts	Watts
Operating Temperature	+15 to +35	+15 to +35	° C
Materials	Aluminum	Aluminum	Aluminum
Coating-Finish	Chemical Film	Chemical Film	
Flange	WR90 (UBR-100)	WR90 (UBR-100)	