

RADITEK

Isolators and Circulators, Drop-In RADI/C-280-430M-SL-1WR

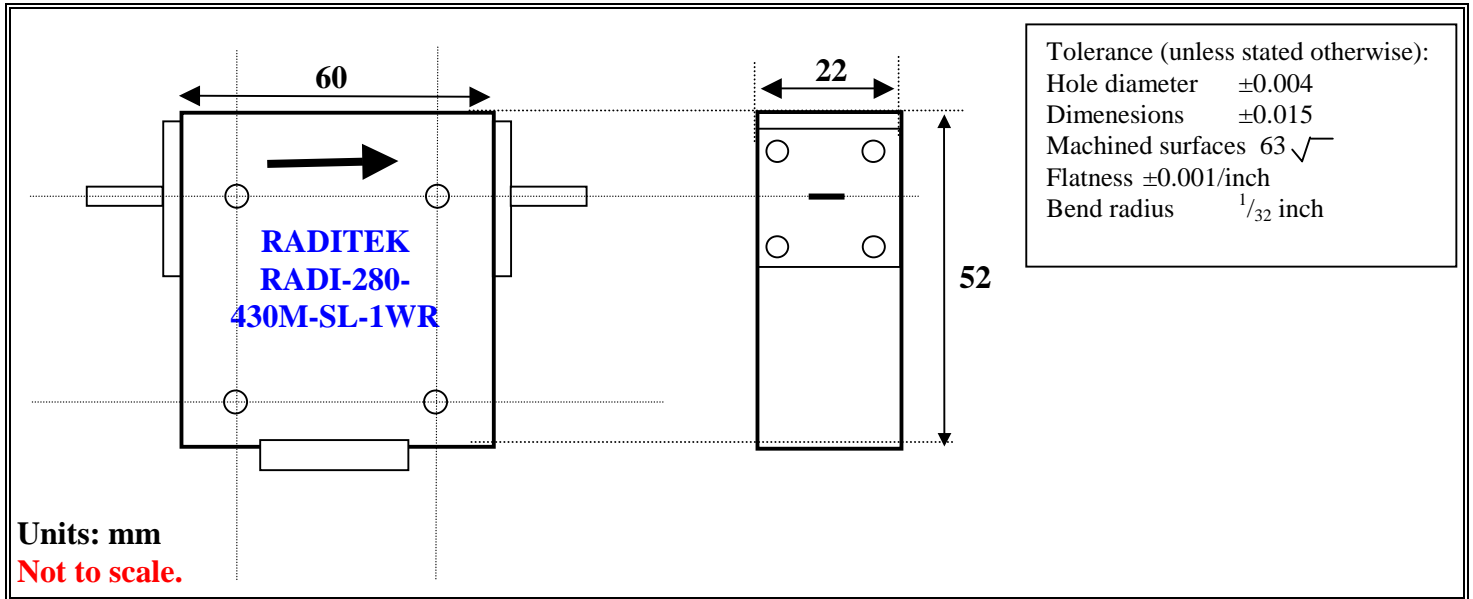

Specifications:	280-430	280-430	280-430	MHz
Bandwidth	Full	15%	5%	
Insertion loss	1.0	0.6	0.4	dB (maximum)
Isolation	15	20	25	dB (minimum)
VSWR	1.6:1	1.6:1	1.6:1	
Rated power (reverse)	1	1	1	Watts (average) {power in load}
Operating temperature	0 to +50	0 to +50	0 to +50	°C