

RADITEK INC.

SMR Filters

code-k

Band Pass Filter, 806-821MHz, 4 poles, 3 Watts, Surface Mount RBPF-806-821M-4p-3W-S-k

1. FEATURES

- ▶ HIGH PERFORMANCE
- ▶ HIGH RELIABILITY
- ▶ SMD TYPE
- ▶ BPF

2. Electrical specification

| ITEM | In >>> Out | |
|--------------------------|------------|------------|
| 1) Center frequency (Fo) | 813.5 | MHz |
| 2) Poles | 4 | |
| 3) Band-width(BW) | +/- 7.5 | MHz |
| 4) Insertion Loss | 3 | dB max. |
| 5) Ripple at BW | 1.0 | dB max. |
| 6) Return Loss | 15.0 | dB min. |
| 7) Attenuation | +/- 22 MHz | 10 dB min. |
| | +/- 80 MHz | 45 dB min. |
| | | |
| | | |
| | | |
| | | |
| 8) Input Power | 3 | W max. |
| 9) In/Out Impedance | 50 | ohm |
| 10) Temperature range | -30 to +85 | °C |

RADITEK INC.

SMR Filters

code-k

Band Pass Filter, 806-821MHz, 4 poles, 3 Watts, Surface Mount RBPF-806-821M-4p-3W-S-k

3. Mechanical specification (Figure,Circuit,Port)

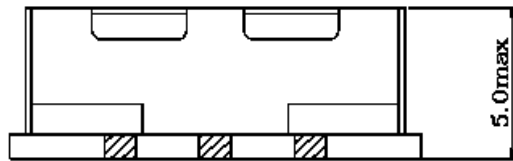
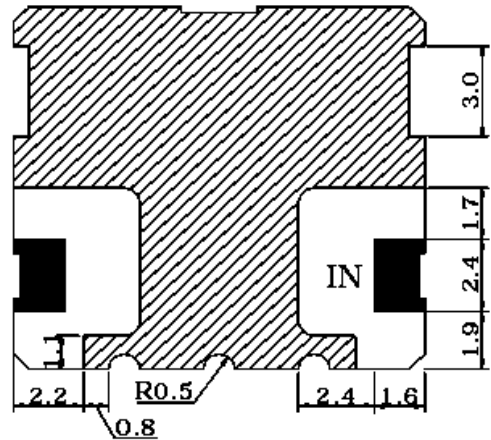
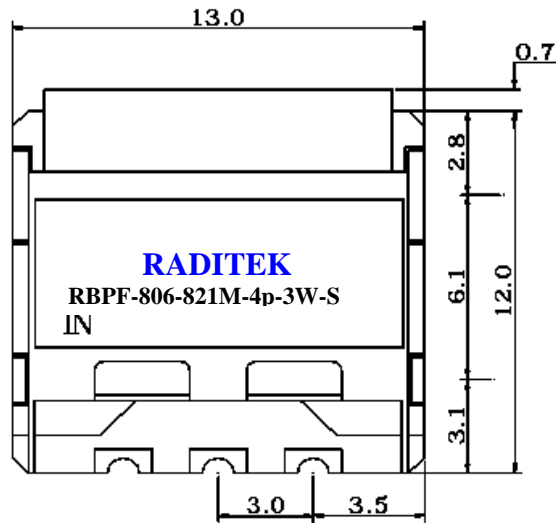

■ : I/O PORT
▨ : GROUND
TOLERANCE UNLESS
OTHERWISE SPECIFIED : +0.2
DIMENSIONS : mm

4. RECOMMENDED PC BOARD PATTERN

■ : SOLDER LAND PATTERN

