

**ROHS Compliant**

# RADITEK INC.

## Ceramic Band Pass Filter

code-k

**980MHz – 6.54 GHz, Split Bands, Model 2614, 3 Watts, Surface Mount**

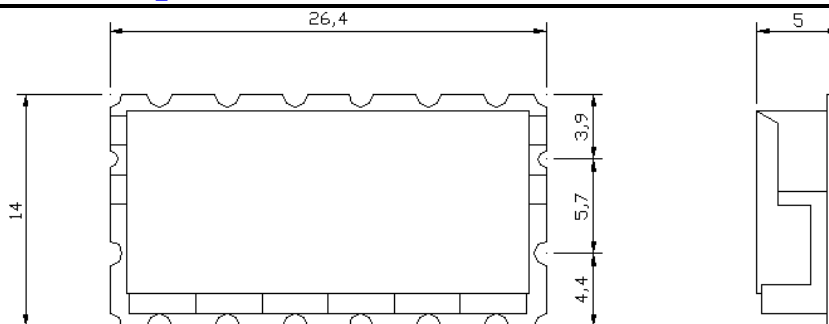

Units: mm  
Not to scale  
Tolerance  $\pm 0.3$

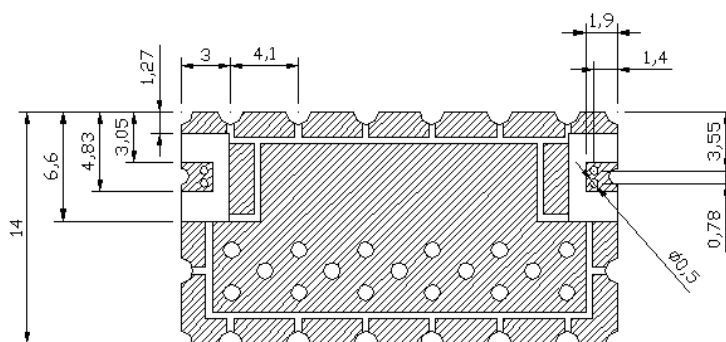

**Order Examples: RBPF-980-1200M-2614-3W-S-k**  
Description: (Band Pass Filter, 980-1200 MHz, Model 2614, 3 Watts, Surface Mount)

Input Power (max) 3 Watts		Operation Temperature Range -20 to +85°C				
SPECIFICATIONS	Center Frequency MHz	Band width MHz	Insertion Loss dB max	Ripple dB max	VSWR	Attenuation
Part Number						
RBPF-980-1200M-2614-3W-S-k	1090	220	Fo2.0	1.0	1.5:1	50 dB min at DC~800 MHz 40 dB min at 850 MHz 25 dB min at 900 MHz 20 dB min at 1350 MHz 35 dB min at 1500 MHz 50dB min at 1700~2400 MHz
RBPF-1588-1612M-2614-3W-S-k	1600	24	4.5	0.4	1.7:1	43dBc min at 1555MHz 40dBc min at 1645MHz 45dBc min at DC~1540MHz 40dBc min at 1650~3800MHz
RBPF-1576-1624M-2614-3W-S-k	1600	48	4.0	0.5	1.5	43dBc min at 1526MHz 43dBc min at 1674MHz 45dBc min at DC~1510MHz 43dBc min at 1690MHz 45dBc min at 1750~3800MHz

**RBPF-980-6540M-2614-3W-S-k (Generic) Specifications may be subject to change**

**05/16/08**

WORLD HQ: 1702L Meridian Ave. Suite 127, San Jose, Ca 95125, U.S.A.

Telephone: (408) 266-7404 FAX: (408) 266-4483

WEB: [www.raditek.com](http://www.raditek.com), E-mail: [sales@raditek.com](mailto:sales@raditek.com)

## Ceramic Band Pass Filter

code-k

### 980MHz – 6.54 GHz, Split Bands, Model 2614, 3 Watts, Surface Mount

SPECIFICATIONS Part Number	Center Frequency MHz	Band width MHz	Insertion Loss dB max	Ripple dB max	VSWR	Attenuation
RBPF-1450-1750M-2614-3W-S-k	1600	300	1.2	0.5	1.5	60dBc min at 1300MHz 45dBc min at DC~1290MHz 45dBc min at 2600~3400MHz
RBPF-1728-1752M-2614-3W-S-k	1740	24	4.5	0.4	1.7	43dBc min at 1695MHz 40dBc min at 1785MHz 45dBc min at DC~1680MHz 40dBc min at 1800~3800MHz
RBPF-1820.5-1831.5M-2614-3W-S-k	1826	11	Fo 10.8	1.0	1.7	80dB min at 1726MHz 80dB min at 1926MHz
RBPF-1867-1937M-2614-3W-S-k	1902	70	Fo 2.6	1.0	1.7	60dB min at 1782MHz 73dB min at 2087MHz
RBPF-2460-2940M-2614-3W-S-k	2700	480	3.0	1.0	1.7	10dB min at Fo ± 300MHz 30dB min at Fo ± 300MHz
RBPF-3230-3290M-2614-3W-S-k	3260	60	5.0	0.5	1.4	15dBc @ 3325MHz 65dBc @ 3510MHz
RBPF-3300-3800-2614-3W-S-k	3550	500	3.0	0.5	1.7	10dB min at Fo ± 350MHz
RBPF-3950-4050M-2614-3W-S-k	4000	100	3.0	0.5	1.7	45dB min at DC~3745MHz 25dB min at 3845MHz 22dB min at 4160MHz 45dB min at 4270MHz 60dB min at 4400~6000MHz
RBPF-4800-5200M-2614-3W-S-k	5000	400	3.0	0.5	1.7	25dB min at 5500MHz 30dB min at 4500MHz 40dB min at 5700MHz 40dB min at DC~4300MHz
RBPF-5849-5921M-2614-3W-S-k	5885	72	5.0	1.2	1.7	30dB min at Fo +/- 140MHz
RBPF-6060-6540M-2614-3W-S-k	6300	480	3.0	1.0	1.7	5dB min at Fo ± 300MHz 30dB min at Fo ± 300MHz