

RADITEK INC.

Triplexer, Cavity Filter, 902-1805-2100MHz, N Female Connectors, 100 Watts
RCTRIP-902-1805-2100-N-100W-k

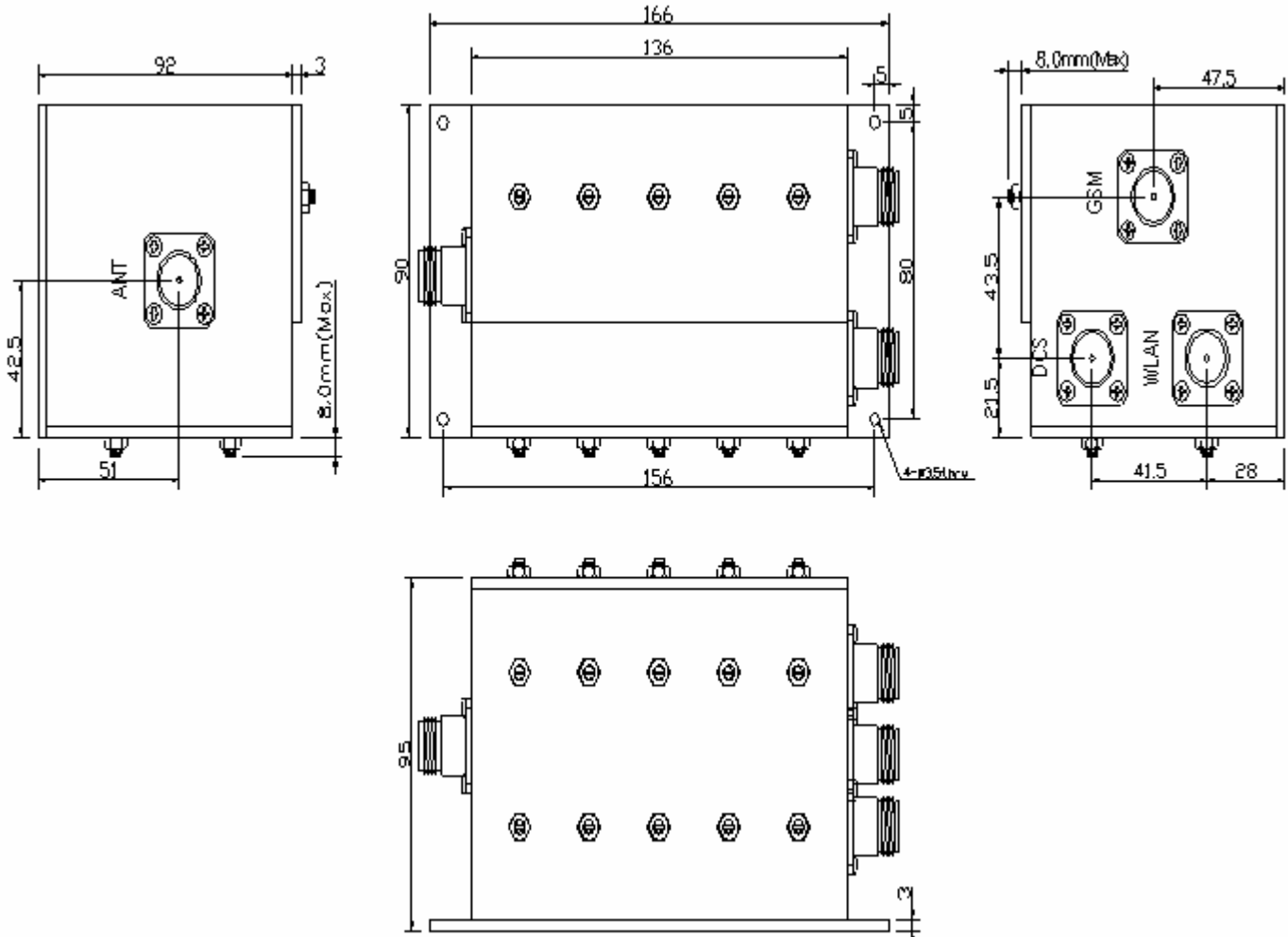

Item	CH1	CH2	CH3
Center Frequency (= Fc)	931 MHz	1842.5 MHz	2140 MHz
Pass Bandwidth (= BW)	Fc+29MHz (902~960)	Fc+37.5MHz(1805~1880)	Fc+30MHz(2110~2170)
Insertion Loss @ BW	0.5 dB max.		
Ripple @ BW	0.3 dB max.		
Return loss @ BW	18 dB min.		
In, Output Impedance	50 Ω		
Input Power	100W max.	100W max.	100W max.
Attenuation	30dBc min. @1805~2170MHz	30dBc min. @902~960 30dBc min. @2110~2170MHz	30dBc min. @902~1880MHz
Operation Temp. Range	-20°C ~ +70°C		