

CIRCULATOR, STRIPLINE DROP-IN

code-b

136 TO 174 MHz, 175 WATTS

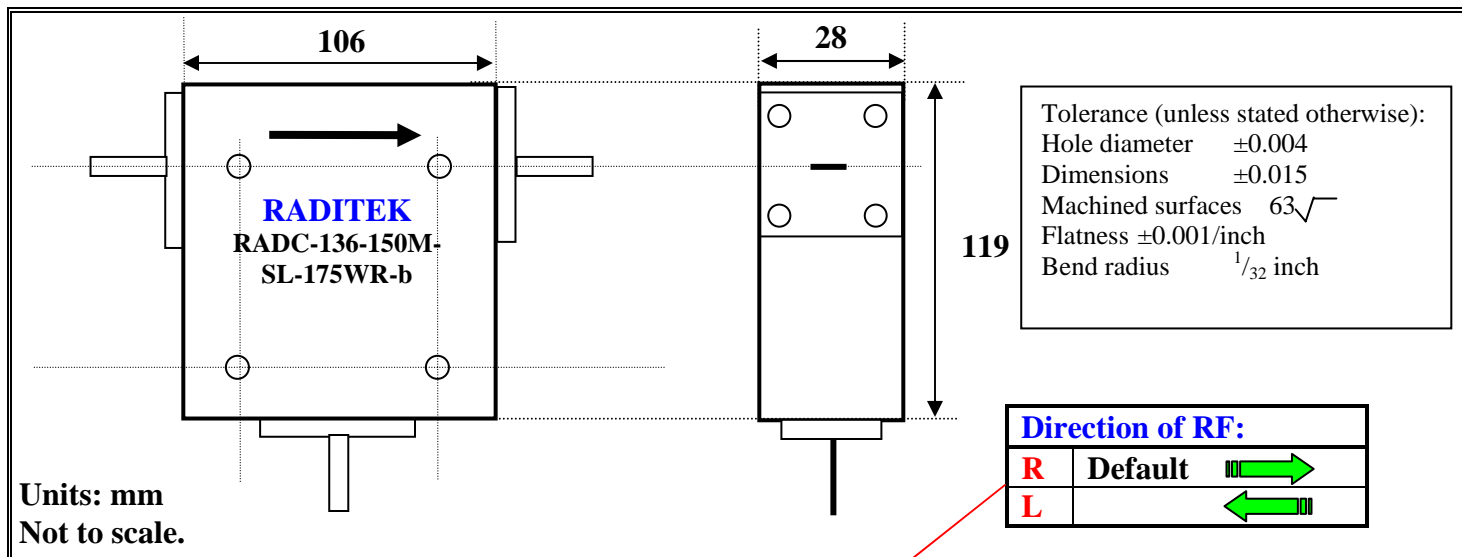

Order Examples: **RADC-136-150M-SL-175WR**

Specifications			Units
Frequency	136-150	150-174	MHz
Insertion loss	0.35	0.35	dB max
Isolation	20	20	dB min
Return Loss	20	20	dB min typical
Power	175	175	Watt
Operating temperature	-30 to 80 C	-30 to 80 C	°C